

**COLLI-PEE® For customized standardized first-void urine collection**

As a trusted partner of diagnostic companies, Novosanis develops customized versions of Colli-Pee® for improved diagnostic accuracy and patient comfort. Bespoke tube design allows high-throughput processing, centrifugation and workflow optimization.



Successful automation starts with sampling



**UCM-Preservative For improved preservation of urine sample**

The collection tube of the Colli-Pee® device contains a UCM (Urine Conservation Medium) buffer for a general preservation of the urine during storage and transport. This will allow for storage at ambient temperature for up to 7 days. The combination with the UCM preservative is CE-marked.

1. Hessels & Schalken. 2013
2. Theodorescu et al. 2008
3. Govers et al. 2018

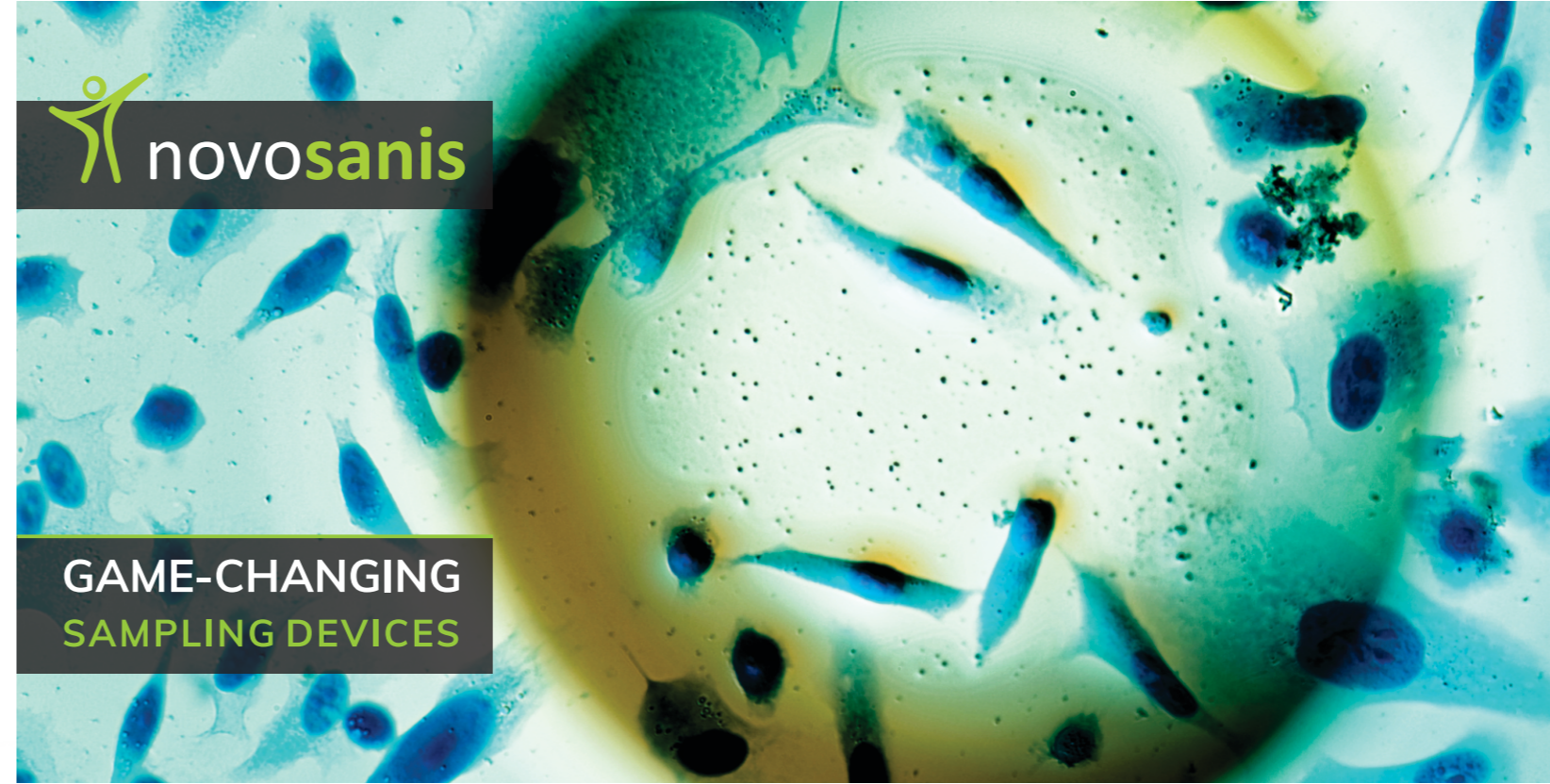

**TOWARDS A WORLD WITHOUT PROSTATE CANCER**

*“Prostate cancer is the most frequently diagnosed cancer and the second leading cause of death among men in Western countries.”*

To successfully cure patients with prostate cancer it is important to detect the disease at an early stage.

Current screening techniques are based on a measurement of serum prostate specific antigen (PSA) levels and a digital rectal examination (DRE). Drawbacks of PSA testing are its low sensitivity and specificity.

Recently, prostate cancer specific markers for the early detection of disease and the prediction of aggressiveness of a prostate tumor have become available.



1.1 MILLION MEN DIAGNOSED WITH PROSTATE CANCER IN 2012



307,000 MEN DIED FROM PROSTATE CANCER IN 2012



EARLY DETECTION OF PROSTATE CANCER IN FIRST-VOID URINE





**Colli-Pee®**

**COLLI-PEE® A user-friendly first-void urine collection device suitable for self-sampling**

Because of the ease of collection and the fact that prostate cells are directly released into the urethra through prostatic ducts after DRE or prostate massage, urine has become the future of non-invasive biomarker testing.<sup>1</sup>

In 2008, Theodorescu et al. found that mid-stream urine was uninformative, but first-void urine was able to identify patients with prostate cancer with 91% sensitivity and 69% specificity.<sup>2</sup>

- o Volumetric and standardized first-void urine collection
- o Allows hygienic and non-invasive self-sampling (at home)
- o No need to interrupt the urine flow
- o Collector tube prefillable with preservative

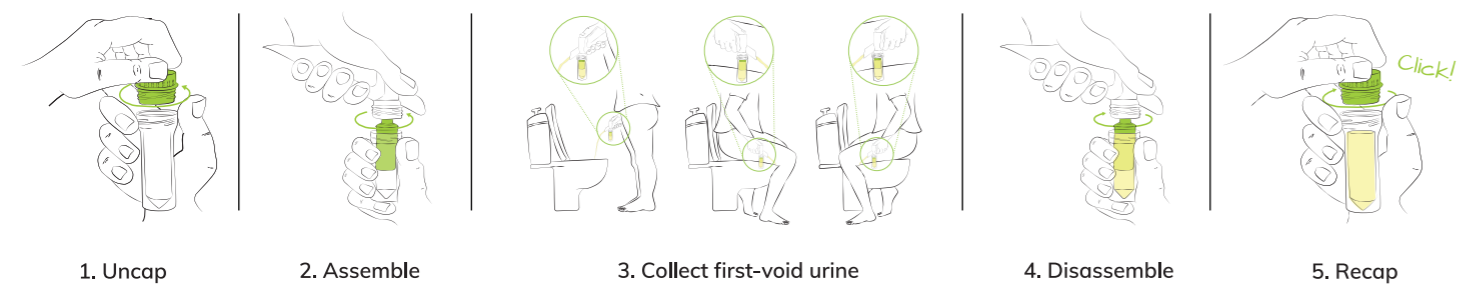

**COLLI-PEE® An innovative approach to non-invasive prostate cancer testing**

Several DNA, RNA, proteins and metabolite-based prostate cancer biomarkers for early diagnosis and follow-up of prostate cancer tumors have been identified.

Many studies have shown the feasibility of urine for the non-invasive detection of prostate cancer but the quality of the sample and analytical procedures utilized are critical components of these assays.

The use of the urinary biomarker-based test SelectMDx® decreases the number of unnecessary biopsies needed and has the potential to reduce over-treatment of insignificant prostate cancers. This strategy results in health gain (QALY) and cost savings.<sup>3</sup>



*"It is well-timed that our UrNCollect™ device is launching as a complement to the SelectMDx® IVD PCR kit because pilot studies demonstrated that patients and physicians found the device easier to use than traditional urine collection tubes."*

**Dr. Jan Groen**  
CEO of MDxHealth®

 **STANDARDIZED FIRST-VOID**

 **COST EFFECTIVE APPROACH**

 **USER FRIENDLY**